

High-Efficiency Toilet Rebate Program

List of Qualifying Toilets



Effective January 1 through June 30, 2009

You must choose a toilet from your water agency's
List of Qualifying Toilets to qualify for a rebate.

Not all fixtures are available in all locations at all times.

Determining Your Existing Toilet's Flush Volume

You must replace a working toilet flushing 3.5 gallons per flush or higher to qualify for a rebate.

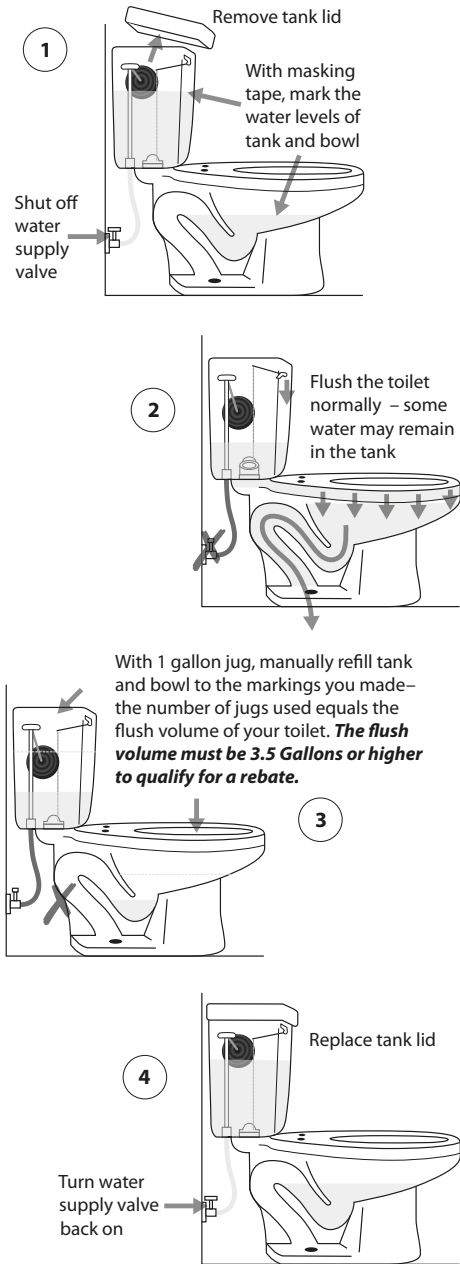

Selecting a Model

We recommend that you consult with a licensed plumber to select and install your toilets.

It is the responsibility of the applicant to determine the suitability of the site for installation of High-Efficiency Toilets.

VERY IMPORTANT:

Manufacturers' toilet model numbers can be confusing. In order to qualify for a rebate, the HET you purchase must match EXACTLY to the model numbers on the List of Qualifying Toilets.

EXAMPLES:

TOTO CST744E

KOHLER K-3496-HE

TOTO CST744S

KOHLER K-3496

Basic Types Of HETs

A pressure-assist toilet has a sealed vessel inside the tank that contains air, which becomes pressurized when water from the supply line fills the vessel. When the flush button is pressed, the pressurized air exerts force on the water in the vessel and the water shoots into the bowl, creating a very fast flush that has a "whooshing" sound.

The noise level of a pressure-assist toilet is slightly greater than standard gravity-flush toilets. However, the result is a reliable flush.

Some HETs are also dual-flush, which allows you to select the amount of water that is used to flush the toilet. There are different style buttons and levers that control the toilet flush volume, as seen in the examples to the right.

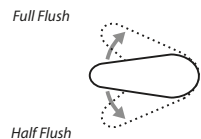
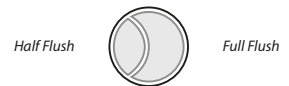

MANUFACTURER	MODEL NAME & DESIGN	MODEL NUMBER				
		COMBINATION	BOWL	TANK	MAP	FLUSH TYPE
	Cadet 3 FloWise EL	2832.128	3014.128	4021.128	1,000	GF
	Cadet 3 FloWise EL ADA	3305.128	3016.128	4021.128	1,000	GF
	Cadet 3 FloWise EL ADA	2835.128	3016.128	4021.128	1,000	GF
	Compact Cadet 3 FloWise EL ADA	2403.128,			1,000	GF
	Compact Cadet 3 FloWise EL ADA	2568.128			1,000	GF
	Compact Cadet 3 FloWise EL ADA	2403.500			1,000	GF
	FloWise Dual Flush EL	2479.216	3067	4035.216	900	DF
	FloWise Dual Flush EL	2476.216	3067	4035.216	900	DF
	Cadet 3 FloWise RF	2829.128	3011.128	4021.128	800	GF
American Standard	FloWise Dual Flush EL (insulated)	2479.516	3067	4035.516	800	DF
	FloWise Dual Flush EL (insulated)	2779.516	3067	4035.516	800	DF
	FloWise Dual Flush EL (insulated)	2476.516	3067	4035.516	800	DF
	Mainstream FloWise RF	3468.128	3061.428	4061.428	800	GF
	FloWise EL	2073.014	3018	4023.014	750	GF
	FloWise Dual Flush EL ADA	2480.216	3073	4035	600	DF
	FloWise Dual Flush EL ADA	2484.216	3073	4035	600	DF
	FloWise Dual Flush EL ADA	2566.216	3073	4035	600	DF
	FloWise Dual Flush EL ADA	2778.516	3073	4035	600	DF
	FloWise EL	2073.014	3018	4023.013	550	GF
	FloWise Dual Flush EL ADA (insulated)	2480.516	3073	4035.516	500	DF
	FloWise Dual Flush EL ADA (insulated)	2484.516	3073	4035.516	500	DF
	FloWise Dual Flush EL ADA (insulated)	2566.516	3073	4035.516	500	DF
Ayers Bath (Tangshan)	Dofiny - EL ADA	UACT1301	UAC1301BS-AA	UAT1302-AA	550	GF
Capizzi	Turbo Capizzi High Profile EL		0478	1578	500	PA
	Turbo Capizzi Low Profile EL ADA		0441	1513	500	PA
	Sydney 270 EL ADA		609120	622320	1,000	DF
	Sydney 305 RF		609151A	622320	1,000	DF
	Bondi 270 EL ADA		609120	726350	900	DF
	Royale 270 RF ADA		609177	624530	900	DF
	Royale 270 EL ADA		609120	624530	850	DF
	Royale 305 EL		609130	629530	850	DF
Caroma	Sydney Smart 270 EL ADA		609120	622322	850	DF
	Caravelle 1-Piece EL ADA	989668			800	DF
	Caravelle 270 EL ADA		609120	629435	800	DF
	Royale 270 EL		609100	624530	800	DF
	Adelaide 270 Cube EL		834000	814790	700	DF
	Adelaide 270 EH Cube RF ADA		825500	814790	700	DF

MaP - Maximum Performance test result.

For a further explanation of MaP please visit www.marinwater.org

RF= Round Front

EL= Elongated

ADA= Americans with Disabilities Act compliant

DF= Dual Flush

GF=Gravity Fed

PA= Pressure Assist

MANUFACTURER	MODEL NAME & DESIGN	MODEL NUMBER				FLUSH TYPE
		COMBINATION	BOWL	TANK	MAP	
	Adelaide 270 EH Standard RF ADA		825500	814328	700	DF
	Adelaide 270 Standard EL		834000	814328	700	DF
	Brisbane 270 RF		833900	810266	700	DF
	Colonial 270 RF		605320	625070	700	DF
	Caravelle 305 RF	989680	609151	629435	650	DF
	Reflections 270 RF	989720	609159	629530	650	DF
	Sydney Low Profile 270 EL ADA		609177	622330	650	DF
	Sydney Smart 305 RF		609151A	622322	650	DF
	Bondi 270 CC RF		609159	726350	600	DF
	Colonial 270 RF		605310	625070	600	DF
	Reflections 305 RF		609151	629530	600	DF
	Royale 270 RF		609159	624530	600	DF
	Royale 305 RF		609151	624530	600	DF
Caroma (Continued)	Sydney 270 RF		609159	622320	600	DF
	Sydney 270 RF ADA		609177	622320	600	DF
	Bondi 270 EL		609100	726350	550	DF
	Bondi 270 RF ADA		607177	726350	550	DF
	Sydney Low Profile 270 EH EL ADA		609120	622330	550	DF
	Sydney Low Profile 270 EL		609100	622330	550	DF
	Sydney Low Profile 270 RF		609159	622330	550	DF
	Sydney Low Profile 305 EL		609130	622330	550	DF
	Tasman 270 RF	989860	609169	800032	550	DF
	Caravelle 270 EL		609100	629435	500	DF
	Caravelle 270 RF	989760	609159	629435	500	DF
	Caravelle 305 EL		609130	629435	500	DF
	Caravelle One-Piece RF	989646			500	DF
	Reflections 270 EL		609100	629530	500	DF
	Sydney 270 EL		609100	622320	500	DF
	Sydney 305 EL		609130	622320	500	DF
	Sydney Low Profile 305 RF		609151A	622330	500	DF
	Walvit EL (ADA optional)		604119	227001 (concealed in-wall)	500	DF
Cascadian	Toscano EL ADA		C930	T901	1,000	GF
	None RF		4710BFZU	(one piece)	600	DF
Contrac	None RF		4720BFZ	combination (lined)	600	DF
	None RF		4720BFZU	combination	550	DF
	None RF		4710BFZ	(one piece with insulated)	500	DF
Crane	Ecomiser Bigfoot EL	38345	31125	31500	1,000	DF

MaP - Maximum Performance test result.

For a further explanation of MaP please visit www.marinwater.org

RF= Round Front

EL= Elongated

ADA= Americans with Disabilities Act compliant

DF= Dual Flush

GF=Gravity Fed

PA= Pressure Assist

MANUFACTURER	MODEL NAME & DESIGN	MODEL NUMBER					FLUSH TYPE
		COMBINATION	BOWL	TANK	MAP		
	Ecomiser Bigfoot EL ADA	38355	31128	31500	1,000	DF	
	EcoMiser EL	38340	3824	31500	1,000	PA	
	EcoMiser EL	38350	3825	31500	1,000	PA	
	EcoMiser EL ADA	38380	3828	31500	1,000	PA	
	Ecomiser One Bigfoot RF	38335	31124	31500	1,000	DF	
	Economiser One Bigfoot EL	31885	31125	31612	1,000	PA	
	Economiser One Bigfoot EL ADA	31888	31128	31612	1,000	PA	
	Economiser One Bigfoot RF	31884	31124	31612	1,000	PA	
	Economiser One EL	31945	3825	31612	1,000	PA	
	Economiser One EL ADA	31948	3828	31612	1,000	PA	
Crane (Continued)	Economiser One RF	31944	3824	31612	1,000	PA	
	Eco Galaxy/Cranada EL ADA	31009	3815	31590	800	DF	
	Eco Galaxy/Cranada EL ADA	31069	3815	31593 (insulated)	800	DF	
	Eco Galaxy/Cranada RF	31067	3352	31593 (insulated)	600	DF	
	Eco Opus III RF	31692	31562	31542	600	GF	
	Eco Saratoga EL ADA	31983	3815	31964	600	DF	
	Eco Saratoga EL ADA	31996	3815	31966 (insulated)	600	DF	
	Eco Saratoga RF	31972	3352	31964	600	DF	
	Eco Galaxy/Cranada EL	31008	3372	31590	500	DF	
	Eco Galaxy/Cranada RF	31007	3352	31590	500	DF	
	Eco Saratoga EL	31973	3372	31964	500	DF	
Duravit	Duravit	Happy D RF	017009	091000-05	600	DF	
	Happy D Wallmount RF		017109	111.335 in-wall (Geberit)	600	DF	
Eljer	Power 1-G EL	091-7625	131-7625	141-7600	800	PA	
	Power 1-G EL ADA	091-7675	131-7675	141-7600	800	PA	
	AIO RF ADA	AIO1000-R	AIOB1000-R	AIOT1000	1,000	DF	
	AIO EL ADA	AIO1000-E	AIOB1000-E	AIOT1000	1,000	DF	
	Gemini Dual-Flush RF	TL-2005-L	LL-2005	T-2005-L (lined)	800	DF	
Foremost	Rona Collection EL	TL-8267-WL	LL-8267	T-8267 (lined)	700	DF	
	Total - RF	TT-2010-*L	LL2010	T-2010 (lined)	600	DF	
	Gemini Dual-Flush RF ADA	TL-2100-*L	(one-piece)		500	DF	
	Plaza	TL-7107-*L	LL-7107	T-7107	500	DF	
	Ultra Dual Flush EL	DF-21-312	21-372	DF-28-380	1,000	DF	
	Ultra Dual Flush EL	DF-21-314	21-372	DF-28-384	1,000	DF	
Gerber	Ultra Dual Flush EL ADA	DF-21-318	21-377	DF-28-380	1,000	DF	
	Ultra Dual Flush EL ADA	DF-21-324	21-377	DF-28-384	1,000	DF	
	Ultra Dual Flush EL ADA (rear discharge)	DF-21-325	21-375	DF-28-380	1,000	DF	

MaP - Maximum Performance test result.

For a further explanation of MaP please visit www.marinwater.org

RF= Round Front

EL= Elongated

ADA= Americans with Disabilities Act compliant

DF= Dual Flush

GF=Gravity Fed

PA= Pressure Assist

MANUFACTURER	MODEL NAME & DESIGN	MODEL NUMBER				
		COMBINATION	BOWL	TANK	MAP	FLUSH TYPE
	Ultra Dual Flush EL ADA (w/bedpan lugs)	DF 21-319	21-329	DF-28-390	1,000	DF
	Ultra Dual Flush RF	DF-21-302	21-342	DF-28-380	1,000	DF
Gerber <i>(Continued)</i>	Ultra Dual Flush RF	DF-21-304	21-342	DF-28-384	1,000	DF
	Ultra Flush RF	EF-21-302	21-342	EF-28-380	1,000	PA
	Ultra Flush RF	EF-21-304	21-342	EF-28-384	1,000	PA
	Ultra Flush EL ADA	EF 21-318	21-377	EF-28-380	800	PA
	Ultra Flush EL ADA	EF-21-312	21-372	EF-28-380	800	PA
	Ultra Flush EL ADA	EF-21-314	21-372	EF-28-384	800	PA
	Ultra Flush EL ADA	EF-21-324	21-372	EF-28-384	800	PA
	Ultra Flush EL ADA (rear discharge)	EF-21-325	21-375	EF-28-380	800	PA
	Ultra Flush EL ADA (w/bedpan lugs)	EF-21-319	21-329	EF-28-390	800	PA
Globe Union	WaterRidge Grace EL	C22055C	(one-piece)		500	DF
Home Depot - Glacier Bay	Ecologic RF ADA	N2225R-165	N2225RB-165	N2225T	1,000	GF
Home Depot - Glacier Bay	Glacier Bay EL ADA		331-725	331-725 (Home Depot SKUs)	600	GF
Home Depot - Pegasus	Dual-Flush RF		SKU 131-926		800	DF
Home Depot - Pegasus	Cottage EL ADA (Flapperless)	N2228	N2228B	N2228T.	500	GF
Home Depot (by Niagara)	Ecologic EL ADA (Flapperless)	N2225E	N2225EB	N2225T.	800	GF
Jacuzzi	Espree (one-piece)		EZ36959 (one-piece)		800	GF
	Cimarron EL ADA	K-3609	4309	4421	1,000	GF
	Cimarron EL ADA	K-11451	4309	4421	1,000	GF
	Kelston EL ADA	K-11453	F4306	F4469	1,000	GF
	San Raphael Power Lite EL ADA	K-3393	Power-Assisted		1,000	DF
	Wellworth Pressure Lite EL	K-3531	4303	4484	1,000	PA
	San Raphael Power Lite EL	K-3393	Power-Assisted		850	PA
	Barrington Pressure Lite EL	K-3652	4327	4484	800	PA
Kohler	Cimarron Eco-Smart EL ADA	K-3496-HE	4286	4634-HE	800	GF
	Sterling Karsten RF	402025	402021	402023	800	DF
	San Raphael Pressure Lite EL ADA	K-3597	(one-piece)		600	PA
	Escale EL	K-3588	4308	4472	500	DF
	Saile EL	K-3564	(one piece)		500	DF
	Highline Pressure Lite EL ADA	K-3519	4304	4484	1,000	PA
Mancesa	Cyclone 4 EL		2282	2281	650	PA
	EcoQuantum EL		147	119	1,000	DF
Mansfield	EcoQuantum EL ADA		148	119	1,000	DF
	EcoQuantum RF		146	119	1,000	DF
	None - EL		144	119	1,000	DF
	QuantumOne EL		147	153	1,000	PA

MaP - Maximum Performance test result.

For a further explanation of MaP please visit www.marinwater.org

RF= Round Front

EL= Elongated

ADA= Americans with Disabilities Act compliant

DF= Dual Flush

GF=Gravity Fed

PA= Pressure Assist

MANUFACTURER	MODEL NAME & DESIGN	MODEL NUMBER				FLUSH TYPE
		COMBINATION	BOWL	TANK	MAP	
Mansfield <i>(Continued)</i>	QuantumOne EL		149	153	1,000	PA
	QuantumOne EL ADA		148	153	1,000	PA
	QuantumOne RF		146	153	1,000	PA
	Prestigio 4 EL		704 (one-piece)		950	PA
	None - EL		144	153	900	PA
	EcoQuantum EL		149	119	550	DF
	Glacier Bay Ecologic RF ADA	N2225R-165	N2225RB-165	N22225T	1,000	GF
	None EL		N2310 2310B	2310T	1,000	PA
	None RF		N4416 N4416	N4415T	1,000	GF
Niagara	Ecologic EL ADA HET (Flapperless)	N2225E	N2225EB	N2225T	800	GF
	Glacier Bay EL ADA	331-725N	331-725	331-725	600	GF
	Ecologic RF HET (Flapperless)	N2225R	N2225RB	N2225T	500	GF
	None EL	N4418	(one piece)		500	GF
Peerless Pottery	Predator EL ADA (by Capizzi)		608	1	500	PA
Pro-Flo	MacLair RF		PF9400	PF9412	900	GF
(by Tynan for Ferguson)	MacLair EL		PF9401	PF9412	850	GF
	Cascade RF		PF9300	PF9312	500	DF
Quality Craft	Alexis HET Dual Flush Toilet in Box EL ADA	30014K	3001	3004 (insulated)	900	DF
	Alexis HET Toilet in a Box - EL ADA	30013K	3001	3003 (insulated)	900	GF
	None - EL ADA		3001/3003 (insulated)		900	GF
	None - EL ADA		3001/3004 (insulated)		900	DF
RAK Ceramics	Venice EL		VN03	VN10	500	DF
	EcoDrake EL ADA	CST744EL	C744EL	ST743E	900	GF
	Aquia EL	CST414M	CT414	ST413M	800	DF
	Gwyneth EL ADA	CST454CEF	C454CE	ST454E	800	GF
	EcoDartmouth EL ADA	CST754EF	C754EF	ST753E	700	GF
	EcoWhitney EL ADA	CST754EFN	C754EF	ST754E	700	GF
	EcoDrake EL	CST744E	C744E	ST743E	600	GF
	EcoUltramax RF	CST853E			550	GF
	EcoUltramax RF	MS853113E			550	GF
	EcoUltramax RF	MW853***E			550	GF
Toto	Aquia II EL	CST416M	CT416	ST416M	500	DF
	Aquia III EL	CST464M	CT464	ST464M	500	DF
	Aquia IIIUH EL ADA	CST464MF	CT464F	ST464M	500	DF
	EcoClayton	CST784EF	C784EF	ST784E	500	GF
	EcoDrake RF	CST743E	C743E	ST743E	500	GF
	EcoNexus EL ADA	CST794EF	CT794EF	ST794E	500	GF

MaP - Maximum Performance test result.

For a further explanation of MaP please visit www.marinwater.org

RF= Round Front

EL= Elongated

ADA= Americans with Disabilities Act compliant

DF= Dual Flush

GF=Gravity Fed

PA= Pressure Assist

MANUFACTURER	MODEL NAME & DESIGN	MODEL NUMBER					
		COMBINATION	BOWL	TANK	MAP	FLUSH TYPE	
Toto (Continued)	EcoSupreme EL	CST864E			500	GF	
	EcoSupreme EL	MS864114E			500	GF	
	EcoSupreme EL	MW864***E			500	GF	
	EcoUltramax EL	CST854E			500	GF	
	EcoUltramax EL	MS854114E			500	GF	
	EcoUltramax EL	MW854***E			500	GF	
	EcoUltramax EL ADA	CST854EL			500	GF	
	EcoUltramax EL ADA	MS854114EL			500	GF	
	EcoUltramax EL ADA	MW854***EL			500	GF	
	Gwyneth EL ADA	CST604CEF			500	GF	
	Gwyneth EL ADA	MW604***CEF			500	GF	
	Gwyneth EL ADA	MS604114CEF		(one-piece)	500	GF	
	Tynan Plumbing	MacLair EL ADA	4347	0347 1342 (Fluidmaster fill valve)		950	GF
MacLair EL ADA		4347	0347	1342 (R&T fill valve)	950	GF	
Avoca EL ADA		4344	0344 1344 (Fluidmaster fill valve)		900	GF	
Avoca EL ADA		4344	0344	1344 (R&T fill valve)	900	GF	
Foyle EL ADA		4345	0345	1345 (R&T fill valve)		900	GF
MacLair RF		4342	0342	1342HET	900	GF	
Nore EL ADA		4346	0346	1346	900	GF	
MacLair EL		4343	0343	1342HET	850	GF	
Foyle EL ADA		4345	0345 1345 (Fluidmaster fill valve)		800	GF	
Cascade RF		4352	0352.01	1312.01	500	DF	
Vitra	Evergreen Dual Flush Comfort EL ADA		5074	5055	800	DF	
	EverGreen RF ADA		5196	5402	800	GF	
	EverGreen EL ADA		5195	5402	600	GF	
	Evergreen EL ADA		5065	5066	500	PA	
	Evergreen Dual Flush RF		5076	5055	500	DF	
Vortens-Lamosa	Hurricane RF ADA		3140	3473	1,000	GF	
	Loretto EL ADA		3140	3475	1,000	GF	
	Rhodas EL ADA (HET)		3123	3436	1,000	DF	
	Tornado EL ADA		3134	3468	1,000	PA	
	Hurricane EL		3137	3473	800	GF	
	Loretto EL		3137	3475	800	GF	
	Loretto RF		3213	3475	800	GF	
	Tornado EL		3138	3468	700	PA	
Vortens-Lamosa	Hurricane RF		3213	3473	600	GF	
	Vienna ELX		3113	3436	600	DF	

MaP - Maximum Performance test result.

For a further explanation of MaP please visit www.marinwater.org

RF= Round Front

EL= Elongated

ADA= Americans with Disabilities Act compliant

DF= Dual Flush

GF=Gravity Fed

PA= Pressure Assist



650-349-3000
www.bawasca.org